

## REMOTE CONTROL - 8 ZONES

## SEQUENCERS FOR LEDS

Ref: 41.025

Controller

CONTROLLER FOR 8 ZONES, MONOCOLOUR, RGB, RGB+CCT, CCT, RGBW (WITHOUT BATTERIES)

Compatible with controllers:

- 41.026
- 41.071
- 40.090



power



voltage



IP20

Product	41.025
Voltage (V)	3V (2 units of AAA not included)
Frequency	2400-2483.5MHz
Measurements	153x47x19mm
Modulation type	GFSK
Signal distance	30m
Fixing	contains a wall bracket that is fixed with a screw included
Packaging	1 unit
Guarantee	2 years

Approved by:

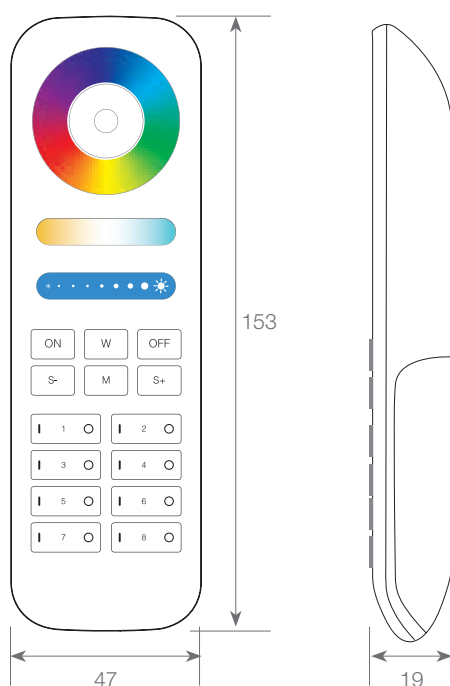

**BARCELONA**  
C/ Carles Buigues, 13  
08420 Canovelles  
Info@luznegra.net  
Tel: +34 938 402 598

**MADRID**  
C/ Adaptación, 27  
28906 Getafe  
centro@luznegra.net  
Tel: +34 916 416 081

**PARIS**  
113 Avenue Joffre  
77450 Esbly  
france@luznegra.net  
Tel: +33 (0) 160 426 585

## REMOTE CONTROL - 8 ZONES

## SEQUENCERS FOR LEDS

### Remote button diagram:

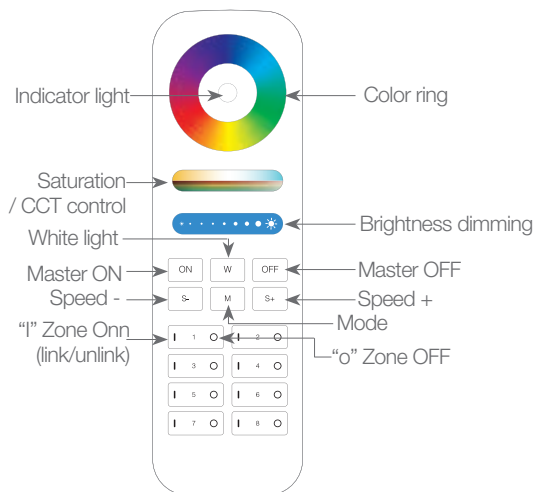

Touch adjustment wheel for desired colour.



In single colour mode it will graduate the intensity, the CTT will change the hue of the earth, in the RGB and -RGBW it will graduate the saturation of the colours and in the RGB+ CTT we will graduate the hue of the whites.



Graduates the intensity of the luminosity in all modes.



Will turn on the white colour only in RGBW and RGB+CTT modes.



Activates all the synchronised controllers in the controller.



Will disable all synchronised controllers on the controller.



Activates and changes the work modes already scheduled. Each installation type has a default number of modes.



Reduces the speed of the working mode.



Increases the speed of the working mode.



In each zone we have the symbol "I" to activate zone, "O" to deactivate the zone.

### Grouping of several lights

You can add an endless number of lights to a zone on the 8 channel remote by linking the lights to different zones. This way you are completely flexible in creating different group combinations. Below you can see some grouping examples.

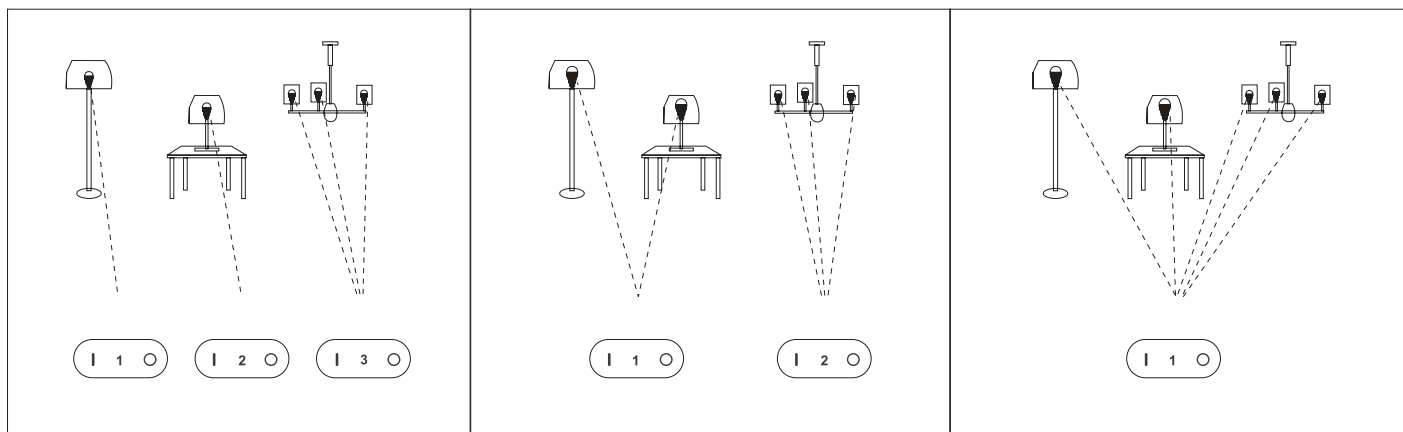

1. The user can re-programme freely as needed. One remote can control countless lights or controllers, but one light or controller can only be controlled by four remotes (Max).
2. Please check the battery installation and controller (totally discharge the power), when you programme after switching off and switching on.

### ATTENTION

1. When using the remote control, if the indicator light is blinking quickly, please change the battery on time. Please don't use poor quality batteries to avoid the leaking of battery liquid which can damage the remote.
2. Please keep your finger off the regulating dial when installing the batteries, to improve its sensitivity. Use the remote control once the batteries have been installed (wait 3 seconds). Please re-insert the batteries if the regulating dial has low-sensitivity.
3. This 2.4G remote is a precise electronic product; don't use it in humid areas, at high temperatures, with dust or in a high voltage environment; keep indoors in a dry environment, free from static electricity.
4. Please don't use the remote on the wide-range metal or strong electromagnetic wave area, otherwise it will badly affect the controlling distance.

## REMOTE CONTROL - 8 ZONES

## SEQUENCERS FOR LEDS

### Link code

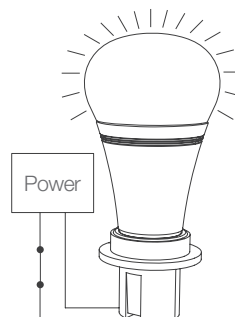
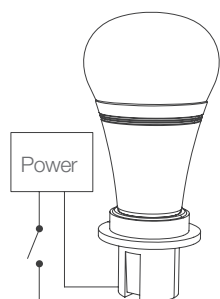

1. Switch off the light and after 10 seconds switch on again.

2. When the light is on, short press any zone of "∩" 3 times (within 3 seconds), after connection.

3. The light blinks 3 times slowly meaning the linking has been done successfully.

If the light does not blink slowly, the linking has failed. Please switch off the light again and follow the above steps once more.

### Unlink code

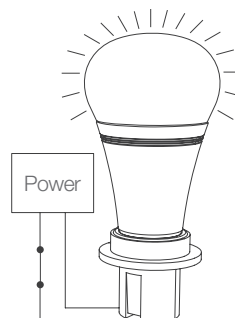
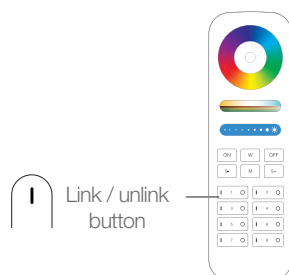
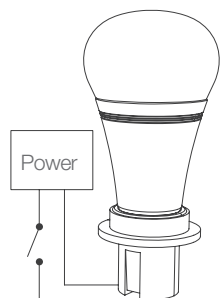

1. Switch off the light and after 10 seconds switch on again.

2. When the light is on, short press any zone of "∩" 5 times (within 3 seconds), after connection.

Unlinking must be the same zone with the linking.

3. The light blinks 10 times slowly meaning the linking has been done successfully.

If the light does not blink slowly, the linking has failed. Please switch off the light again and follow the above steps once more.